

3rd May 2026



# Karibu Kanisani



## **Vision**

Becoming Christ-like Disciples, Engaging the World

## **Mission**

To be a Worshipping Community, helping one another to be obedient to God's Word and to be Ambassadors of Jesus Christ in a needy world

## **SUNDAY SERVICES**

ADULTS | YOUTH | CHILDREN

9:00AM & 11:00AM

## **WEDNESDAY PRAYER SERVICE**

6:00PM - 7:30PM





# *Welcome* **MAY**

We are excited to share the events lined up for this month and invite you to take part, connect, and grow together in the LORD.

THIS SUNDAY...



Study of  
*Exodus*



Sun, May 3rd

SUNDAY SERVICES  
↑

# Faith *in the* Furnace

Exodus 5&6

*With* Wallace Maina

SERVICE TIME 9 AM & 11 AM

WATCH LIVE @KaruraCC

KARURA COMMUNITY CHAPEL YOUTH MINISTRY



# LOOK UP

A Mental Health Series

3rd May - Comfort Amidst Chaos - Is 40:1- 8

10th May - Behold our God- Isaiah 40:9-17

17th May - God is Better - Isaiah 40:18-26

24th May - When God Meets You in the Dark - Gen 16:1-16

31st May - Strength for the Young & Weary - Isaiah 40:27-31

JOIN US SUNDAYS SERVICE TIMES 9AM & 11AM

VENUE Next to Rosslyn Riviera, Limuru Rd

WATCH LIVE Karura Chapel Youth Ministry



# Mental Awareness Month



THIS MAY AT KARURA COMMUNITY CHAPEL



# Beyond "I'M FINE"

Equipping You to Compassionately Handle Suicidal Ideation

## 16th May | Saturday

EQUIPPED TO SERVE  
MENTAL HEALTH RESPONSE FOR CHURCH LEADERS

(Training open to all church co-labourers)

Speaker: Gitau Mary, Millicent Onjoro, Enid Njeri | Time: 10AM

## 17th May | Sunday

THE HIDDEN BATTLE: WHEN THE MIND CRIES OUT

Speaker: Gitau Mary | 9AM & 11AM

## 23rd May | Saturday

STANDING TOGETHER: A WHOLE CHURCH  
RESPONSE TO MENTAL HEALTH

(Open to all)

Speaker: Gitau Mary, Millicent Onjoro, Enid Njeri | Time: 10AM

## 24th May | Sunday

TOGETHER WE ARE HEALING,  
A CHURCH THAT HOLDS SPACE

Speaker: Gitau Mary | 9AM & 11AM

Social Media @KaruraCC  
Website [www.karuracc.or.ke](http://www.karuracc.or.ke)



MILLICENT ONJORO

ENID NJERI

GITAU MARY

# Worship & Community Centre



# City on a Hill Prayers

Speaker  
**Wallace Maina**

Saturday 2nd May 2026 | 8am - 9am  
@ The New Sanctuary Building



# Church Family Life



**KARURA COMMUNITY CHAPEL** **30 Anniversary** **Focus 2026 Engage** **CHURCH FAMILY LIFE NAWIRI**  
Karura Singles Ministry

## SINGLES' MAY '26 FELLOWSHIP

**@ KARURA CC, LIMURU RD** | **1PM-3PM** EVERY SUNDAY OF MAY 2026 AFTER SECOND SERVICE

**LESSONS:**

- Week 1 Financial Wisdom, Life Planning, and Marriage Preparation
- Week 2 Dating, Courtship, and Discernment in Christian Relationships
- Week 3 Social, Cultural, and Gender Dynamics in Modern Christian Dating
- Week 4 Healing, Emotional Health, and Breaking Past Patterns
- Week 5 Identity, Purpose, and Spiritual Foundation in Relationships

For enquiries call 0721990880



**KARURA COMMUNITY CHAPEL** **CHURCH FAMILY LIFE LADIES MINISTRY** **Focus 2026 Engage** **30 Anniversary**

## MOTHER & DAUGHTER Day

**9TH MAY SATURDAY**

**TOPIC: ROOTED IN FAITH, GROWING IN LOVE**  
COLOSSIANS 2:6-7

**@KARURA COMMUNITY CHAPEL, LIMURU ROAD**  
9:30AM - 12:00NOON

[@karuracc](#)  
Karura Community Chapel

[www.karuracc.or.ke](http://www.karuracc.or.ke)

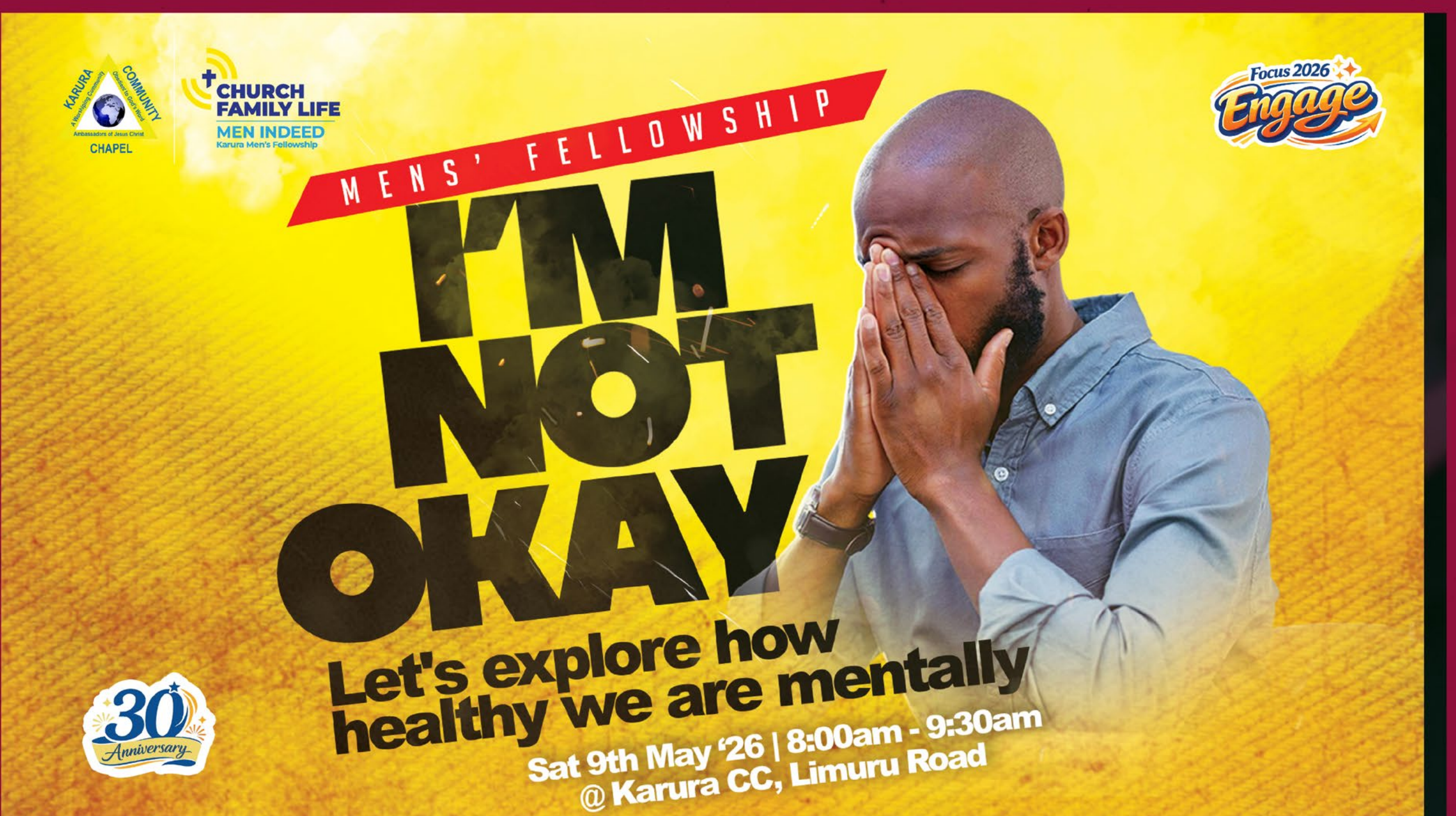

**KARURA COMMUNITY CHAPEL** **CHURCH FAMILY LIFE MEN INDEED** **Focus 2026 Engage**  
Karura Men's Fellowship

## MENS' FELLOWSHIP

# I'M NOT OKAY

Let's explore how healthy we are mentally

Sat 9th May '26 | 8:00am - 9:30am  
@ Karura CC, Limuru Road

**30 Anniversary**



JOHARI LADIES MEETING



# FINANCIAL

SATURDAY  
23<sup>rd</sup>  
May '26

# Investment



SPEAKER

**ESTHER OLOO**

Finance and Investment Consultant,  
Associate Member & Trainer, Chartered Institute of  
Securities & Investments (CISI)  
CEO NinaGina Consulting

Karura CC, Limuru Road | 10am - 12noon



SALAMA FELLOWSHIP

# Reaching Out *to the Separated and Divorced*

VENUE: KARURA CC, LIMURU RD  
TIME: 9AM – 11AM  
CONTACT PERSON: PURITY 0722655799

Sat  
**23<sup>RD</sup>**  
MAY 2026

*The Ministry seeks to support and care for individuals going through divorce/separation.*

## Equipping and Training



Discipleship Course

# FREEDOM *in* CHRIST

In this program you will:

1. Break Through to a greater level of maturity
2. Uncover any areas of deception holding you back
3. Resolve personal and spiritual conflicts
4. Renew your mind and break free from negative thinking and unhelpful patterns of behavior.

Starts: Monday 4th-May 2026 for 10 weeks | Time: 7pm to 9pm

One Physical Session Saturday 9th May 2026

Cost: Kes 3,500 | Paybill: 532900 Account: FIC

To register, Email: [fc@karuracc.or.ke](mailto:fc@karuracc.or.ke) & [executionteamfickarura@gmail.com](mailto:executionteamfickarura@gmail.com)

Contact person: Rahab 0716 457 555



# NEW BELIEVERS CLASSES

**8-WEEK PROGRAMME**  
**7:00PM - 8:00PM | ONE HOUR WEEKLY ONLINE CLASSES**

Contact Pst. Dago - 0714 898 759 to sign up and for more details.

## Karura Centre



# Laikipia Relocation PROJECT

Support the resettlement of a vulnerable family of six to a new home in Laikipia. We are seeking help to build a house and latrine, provide essential household items, and settle four children into nearby schools.

*Individuals, CLGs, and corporates are invited to adopt a budget item and make a difference.*

**BUDGET KES 550K**

Relocation Date: **30th May 2026**  
 Payment Details:  
 Paybill: 720860  
 Acc: Laikipia Relocation

For more information,  
 Email: [queenveil@karuracc.or.ke](mailto:queenveil@karuracc.or.ke)  
 or call 0725783826

## churchwide

# Pre-Service CORPORATE PRAYERS

**EVERY SUNDAY FROM 8:35AM**  
 MID-WEEK PRAYER SERVICE **EVERY WEDNESDAY AT 6:00 PM**



# Youth Ministry

KARURA COMMUNITY CHAPEL YOUTH MINISTRY



**LOOKUP**  
A Mental Health Series

# COMFORT AMIDST CHAOS

ISAIAH 40:1-8



KARURA YOUTH INVITES YOU FOR A

# Hymns Night

FREE ENTRY

22  
MAY  
06  
PM

THEME

Behold *Our God*

Karura Community Chapel, Hekalu  
Next to Rosslyn Riviera, Limuru rd

KARURA COMMUNITY CHAPEL YOUTH MINISTRY



Sun, May 31

Fun. Snacks. Q&A Session

**VENUE:** KARURA COMMUNITY CHAPEL  
Next to Rosslyn Riviera, Limuru rd

**TIME** 1:30 PM - 3:30PM  
Refreshments will be provided.

#KeepingItReal

# June '26 & Beyond



## PLUG IN SEASON 2

10-Week programme leading to church membership

LAUNCH: SAT 30TH MAY 2026  
7PM-8PM | ONLINE



Meeting ID:  
879 4461 2647  
Passcode:  
851451

CLASSES START  
SAT 6TH & SUN 7TH JUNE '26  
9AM - 11AM @KARURA CC

To register, send an email to [plugin@karuracc.or.ke](mailto:plugin@karuracc.or.ke)  
or contact Joan on 0706 272 952

COST INVOLVED  
Guide Book: KES 1,000/-  
Retreat: KES 6,000/-



@karuracc  
Karura Community Chapel



[www.karuracc.or.ke](http://www.karuracc.or.ke)



KARURA COMMUNITY CHAPEL  
FORESIGHT

KARURA MEN'S FELLOWSHIP PRESENTS

# FATHER'S DAY KIKAO

FREE ENTRY | FREE ENTRY  
20  
JUN 26

TIME & PLACE  
1PM-7PM  
@KARURA CC  
FORESIGHT



SPEAKERS

ELDER JOHN NG'ANG'A MR. JOHN KANYONI

TOPIC - EQUIPPING MEN TO LEAD INTENTIONALLY  
WITHIN THEIR HOMES AND RELATIONSHIPS

SCAN TO REGISTER



@karuracc  
Karura Community Chapel

FOR MORE INFO: 0715490372



PRE-MARITAL COUNSELLING CLASSES



# PMCC

# SEASON 2

BEGINS SUNDAY  
21ST JUNE '26  
2PM - 4PM

AT KARURA COMMUNITY CHAPEL, LIMURU ROAD

To register and for more information email [pmcc@karuracc.or.ke](mailto:pmcc@karuracc.or.ke) or call Martin 0723 723 879

# June '26 & Beyond



## Uzima **FREE** Wellness Medical Camp



CALL FOR PARTNERSHIP

Saturday, 11th July 2026  
8:30am - 3:00pm

**Karura Community Chapel**  
Limuru Rd

This camp aims to enable community members to access services that would otherwise be expensive or inaccessible to majority of them. **We need your help in achieving this.**

### PAYMENT DETAILS

**Paybill: 720860**  
**Account: Uzima Medical Camp**

For more info contact: [uzima@karuracc.or.ke](mailto:uzima@karuracc.or.ke) or call 0796212093



## Uzima **FREE** Wellness Medical Camp



CALL FOR VOLUNTEERS

Saturday, 11th July 2026  
8:30am - 3:00pm

**Karura Community Chapel**  
Limuru Rd

We are seeking both medical and non-medical volunteers to join us in making healthcare accessible and affordable for our community. Your support will help provide essential services to those who might otherwise go without. **Join us in this impactful mission!**

### PAYMENT DETAILS

**Paybill: 720860**  
**Account: Uzima Medical Camp**

For more info contact: [uzima@karuracc.or.ke](mailto:uzima@karuracc.or.ke) or call 0796212093



## Uzima **FREE** Wellness Medical Camp



Saturday, 11th July 2026  
8:30am - 3:00pm

**Karura Community Chapel**  
Limuru Rd

### SERVICES TO BE OFFERED

Optical, Dental, ENT, Cancer Screening, Mental wellness, Paediatrics, Obs/ Gynae, Orthopaedics among others

For more info contact: [uzima@karuracc.or.ke](mailto:uzima@karuracc.or.ke) or call 0796212093

# CARE NEEDS

Let us continue to keep the following individuals and families in our prayers and offer them our love and support:

- Joyce Shikuku (Coram DEO CLG/Salama Ministry) whose mum has gone to be with the Lord.
- Carol Kahiga for full recovery and thanksgiving following a successful surgery.
- Grace Karinga and family as their mum is still in hospital.
- All who are struggling with mental health challenges.

If you would like the church to pray with you, please feel free to reach out to our care pastors on the care line: 0721766016.

**Do you have a prayer need?**

**CLICK  
Here to  
let us  
know.**



MALL



**SUNDAY**

# TWO RIVERS MALL PARKING

We are pleased to announce we have been granted parking access at TWO RIVERS MALL Koroga Grounds Parking Lot on Sundays.



**FLAT RATE**  
**KES 100/-**  
**PER VEHICLE**  
(7am -2pm)



**ENTRY/EXIT**  
Limuru Road Gate  
or Southern Bypass  
Main Entrance



**CHURCH ACCESS**  
Pedestrian Gate  
near our church  
(walk in only)



**SECURITY**  
Parking secured  
with Tribus Guard  
on site



**SUPPORT**  
Church parking  
stewards and  
traffic marshalls  
available



**PAYMENT**  
Paytech Assistants  
will handle  
validation and  
payment at the  
Parking Lot.

For more information and assistance call: **0721 990 880**

*We thank God for this provision.  
All Glory goes to Him!*

# KISIMA CHAMPIONS CENTRE

**FOR  
HIRE**

Need a convenient, affordable, well maintained and reliable place to host your meetings? Kisima Champions offers you a over 3,000 square metres, 20+ rooms to hire throughout the week.

#### Event spaces for:

- Weddings
- Album Launches
- Graduation
- Indoor Sports
- Arts & Crafts
- Dinners & Cocktails

#### Amazing Meeting Rooms for:

- Chama Meetings
- Family Gatherings
- Conferences/Workshops/Seminars

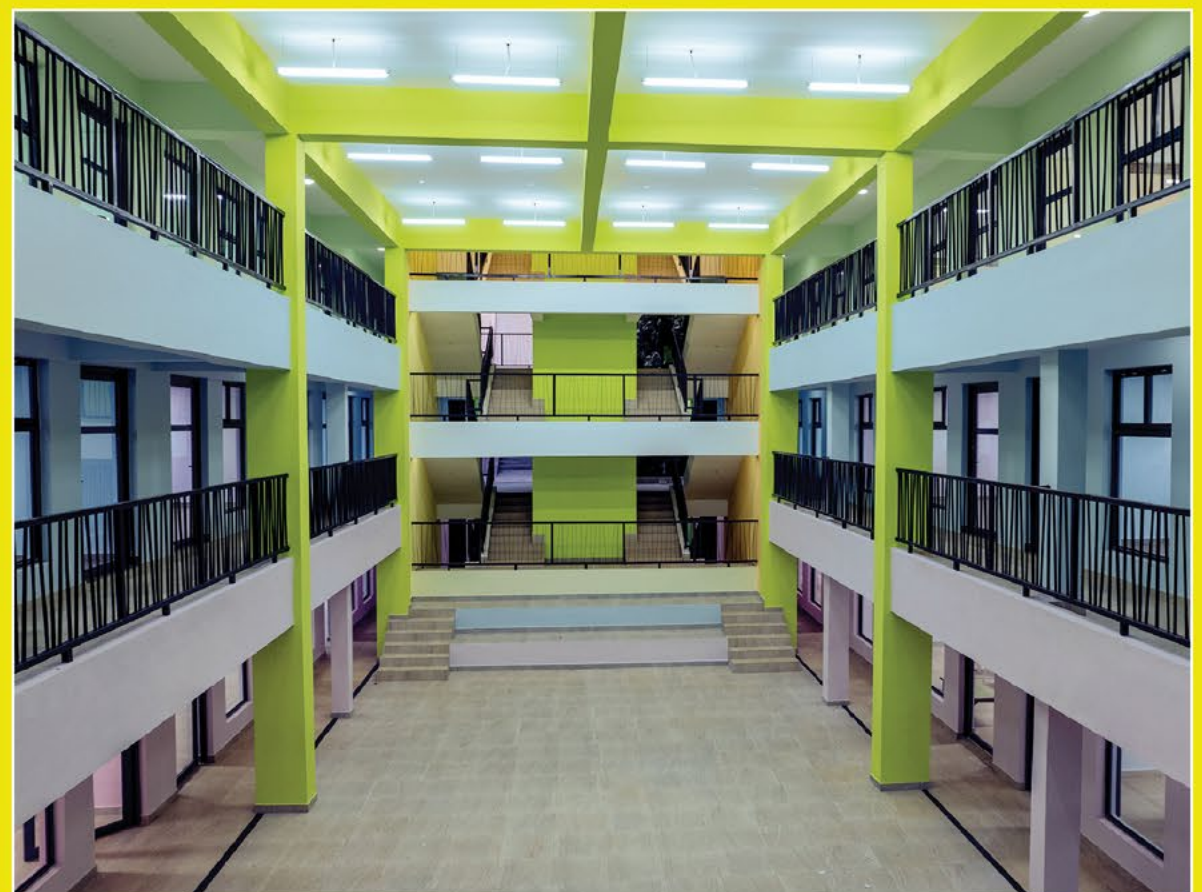

 +254 721 990 880

 Next to Rosslyn Riviera Mall, Limuru Road

 [info@karuracc.or.ke](mailto:info@karuracc.or.ke)  [www.karuracc.or.ke](http://www.karuracc.or.ke)

# RATE CARD

Rooms				
Capacity	Duration	KCC Non Members	KCC Members (CLG/Registered)	No. Rooms
<b>Boardroom Corporate Meetings</b>				
15 pax	Per Hour	2,500	2,000	3
	Rate per month	33,150	22,100	
<b>Kisima Centre Conference Rooms</b>				
30-40pax	Per Day	5,000	4,000	12
	Rate per month	88,400	66,300	
<b>CBC-Related Indoor Games Facilities</b>				
	Per Day	40,000	25,000	2
<b>Weddings &amp; Events</b>				
Capacity	Duration	KCC Non Members	KCC Members (CLG/Registered)	No. Rooms
<b>Kisima Centre &amp; Hall</b>				
250pax	Per Day	70,000	50,000	3
	Per Day	5,000	4,000	12
	Rate per month	88,400	66,300	
<b>Classrooms - Weekday (Evening Meetings) 5:30pm - 8:00pm</b>				
	Per Day	2,000	1,500	12
<b>Main Sanctuary (Mon, Tue, Thur &amp; Fri 8am-8pm), (Wed &amp; Sat 8am-4pm) Sunday 3pm-8pm</b>				
1,200Pax	Per Day	100,000	75,000	1
<b>Hekalu - Youth Sanctuary (Mon - Fri 8am-8pm), (Sat 8am-4pm) Sunday 3pm-8pm</b>				
400 Pax	Per Day	55,000	45,000	1

## OTHER COST FOR WEDDINGS & OTHER LARGE EVENTS

Sound team cost - KShs. 5,000/-

\* For license agreement a monthly flat rate of KShs. 15,000/- will apply for service charge

\* Main Sanctuary & Hekalu a refundable amount Ksh. 20,000/- will apply.

# FREQUENTLY ASKED QUESTIONS (FAQS)

## 1. How do I book a space?

You can book a space by calling our reservations team at 0721990880 or sending us an email to info@karuracc.or.ke who will work with you to reserve and share your booking and payment details.

## 2. What kind of events can I host?

You can host a variety of events including funeral planning meetings, church group meetings, pre-wedding meetings, CLG meetings, weddings, corporate events, corporate or business team buildings or even school related events and many more

## 3. When can I choose to have my meeting/event?

Kisima Champions, Main Sanctuary and Hekalu are available for short term hires on Mondays to Fridays from 8:00am to 8:00pm. Saturdays 8AM-5PM, Sundays 3PM - 8PM

## 4. Can I make payments via Mpesa?

Yes, we accept payments via Mpesa for your convenience.

Bank: KCB

Branch: Village Market

KES. A/C No. 1104059983

USD – GT Bank

Account no. 2250007814

MPESA PAYBILL: 759730

A/C – KCC LICENSE

## 5. In the event that I had made a booking, paid and have to make a cancellation? What happens?

In the event you need to cancel or reschedule a confirmed booking, the funds paid can be held as credit with the Church. This credit can be utilized by you for a future booking. The funds can be refunded 100% if cancellation is done 10 days prior the event. The Church may cancel the booking if the booking will in the reasonable opinion of the Church, prejudice the reputation of the Church.

# WAYS TO Give

MPESA PAYBILL: 532900  
A/C: Tithe and Offering

Bank: KCB  
Branch: Village Market  
KES A/c No: 1104057999

Guaranty Trust Bank  
Branch: Westlands  
A/c No: 2250007814

Pesalink: USD Account

*Cheques payable to  
Karura Community Chapel*

*PDQ Machines are available at the info desk.*

# City on a Hill

MPESA PAYBILL: 759730 | Acc: BUILD

BANKS: KCB  
BRANCH: Village Market  
KES A/C No: 1104059983

Click here to PLEDGE

GT Bank  
USD A/C No: 2250007814

CLICK HERE

TO LISTEN TO OUR WEEKLY PODCASTS

CLICK



TO LIKE, FOLLOW & SUBSCRIBE

Receive regular Church updates via whatsapp

Text 'Hi'

+254 721 990 880

Thank you for making it this far,  
please do share with a friend. 😊